

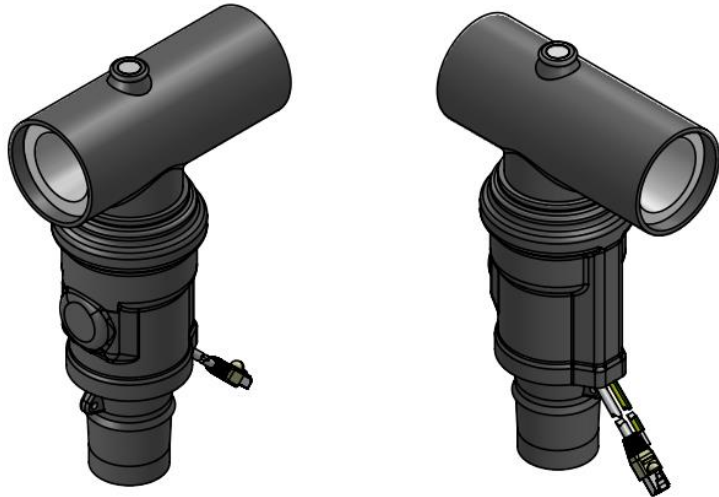

CVS-24-G-ST

SMART PLUG-IN TERMINATION



The **CVS-24-G-ST** is a combinable current / voltage instrument transformer integrated into a separable 24 kV "T" connector. The standard version of sensors is passive, capacitive divider for voltage and rogowski coil for current. An active version is available on request for special applications.

Nominal frequency	50 / 60 Hz
Operating Temperature Range	[-25; + 90] °C
Applicable Standards	IEC 60044-7; 60044-8; ENEL DJ 5400; HD 629.1 S2
Bandwidth (-3 dB)	30 Hz – 10 kHz for VS
	30 Hz – 5 kHz for CS
Accuracy on harmonics	According to IEC 60044-8

Altea CVS-24-G-ST voltage features

Rated insulation level	24/50/125 kV	
Rated primary voltage, U_{pn}	20/ $\sqrt{3}$ kV	
Maximum voltage, U_m	24 kV	
Rated secondary voltage, U_{sn}	1,155 V	
Rated voltage factor, K_u	1,9 for 8h	
Nominal transformation ratio, K_n	10000 / 1	
Accuracy (after calibration correction factor)	Rated Burden	1 MOhm
	Class	0.5

Altea CVS-24-G-ST current features

Rated primary current, I_{pr}	300 A	
Rated extended primary current factor, K_{pcr}	30	
Rated primary time constant for transient performance (active circuit), t_{pr}	25 ms	
Rated short time withstand thermal current, I_{th}	12,5 kA / 1s	
Dynamic nominal current, I_{dyn}	31,5 kA	
Rated Continuous thermal Current, I_{cth}	2 I_{pr}	
Nominal transformation ratio, K_{ra}	1000 A / 0,031 V	
Accuracy (after calibration correction factor)	Rated Burden	10 kOhm
	Class	0.5



www.alteasolutions.com

Altea B.V. · Claude Debussylaan 18 · 1082 MD Amsterdam · The Netherlands

Phone: +31 20 625 6115 · Email: info@alteasolutions.com