

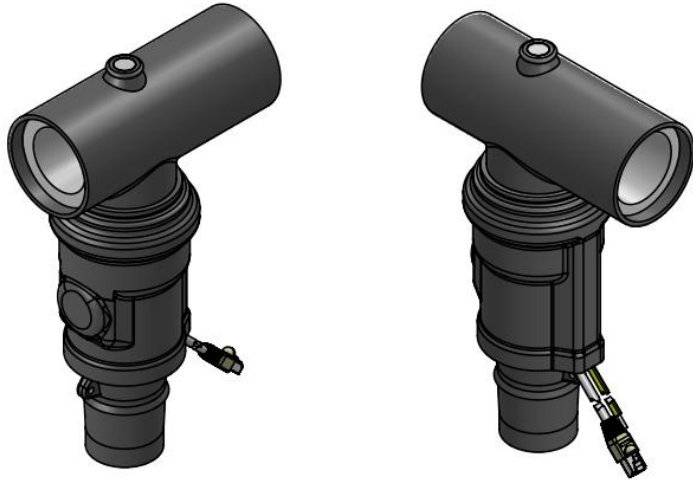

CVS-24-G



The **CVS-24-G** is a combinable current and voltage low-power transformer integrated into a separable 24 kV "T" connector. This active version is available on request for special applications.

* marks parameters that can be customized upon request.

Nominal frequency	50 / 60 Hz
Operating Temperature Range	[-25; + 90] °C
Auxiliary Supply voltage	±5 V _{dc}
Max. Supply Current	15 mA
Applicable Standards	IEC 60044-7; 60044-8; HD 629.1 S2
Bandwidth (-3 dB)	30 Hz – 20 kHz for VS
	30 Hz – 5 kHz for CS
Accuracy on harmonics	According to IEC 60044-8

Altea CVS-24-G voltage features		
Rated insulation level	24/50/125 kV	
Rated primary voltage, U _{pn}	20/√3 kV	
Maximum voltage, U _m	24 kV	
Rated secondary voltage *, U _{sn}	1,1547 V	
Rated voltage factor, K _u	1,9 for 8h	
Nominal transformation ratio *, K _n	10000 V / 1 V	
Accuracy Class	Rated Burden	100 kOhm
	For Protection	3P
	For Measurement *	0,5

Altea CVS-24-G current features		
Rated primary current *, I _{pr}	300 A	
Rated extended primary current factor, K _{pcr}	30	
Rated primary time constant for transient performance (active circuit), t _{pr}	25 ms	
Rated short time withstand thermal current, I _{th}	20 kA / 1s	
Dynamic nominal current, I _{dyn}	31,5 kA	
Rated Continuous thermal Current, I _{cth}	2 I _{pr}	
Nominal transformation ratio *, K _{ra}	300 A / 0,200 V	
Accuracy Class	Rated Burden	10 kOhm
	For Protection	5P30
	For Measurement *	0.5



www.alteasolutions.com

Altea B.V. · Claude Debussylaan 18 · 1082 MD Amsterdam · The Netherlands

Phone: +31 20 625 6115 · Email: info@alteasolutions.com